

# piston seal K08-SE

## seal spec

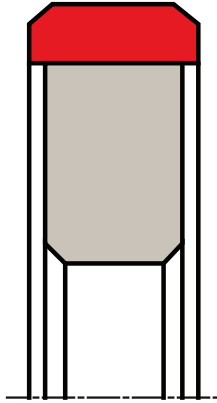

### description

the profile K08-SE piston sealing set is primarily designed for heavy hydraulic applications and is preferably fitted in double-acting pistons. the sealing set is suitable for working pressures up to 500 bar which, under certain conditions, may even be exceeded.

### application



### category of profile

molded/standard/trade product or machined with minor design change.

### double acting

the K08-SE seal is designed for use as a piston seal.

### area of application: hydraulics

### advantages

- small profile.
- resistant against shock loads.
- low break-out and running friction even after extended standstill under high pressures.
- simple installation on solid piston without the necessity of auxiliary tools due to the split design of the cylinder sealing ring.
- high abrasion resistance.
- high extrusion resistance at high pressures and large gaps due to the special compound properties of the cylinder sealing ring.
- perfect static and dynamic sealing function.
- suitable for housings according to ISO 7425-2.

### operating parameters & material

material		temperature	max. surface speed	max. pressure <sup>1</sup>
sealing element	energizer			
thermoplastics	NBR 70 Shore A	-30°C ... + 110°C	1,0 m/s	500 bar (50 MPa)

#### important note:

the above data are maximum values and can't be used at the same time. e.g. the maximum operating speed depend on material type, pressure, temperature and gap value. temperature range also dependent on medium.

<sup>1</sup> pressure ratings are dependent on the size of the extrusion gap.

### surface quality

surface roughness	Rtmax (µm)	Ra (µm)
sliding surface	≤2,5	≤ 0.6
bottom of groove	≤6,3	≤ 1.6
groove face	≤15	≤ 4.0

### tolerance recommendation

seal housing tolerances	
Ød	h9
ØD	H9

**fitting & installation**

the installation groove must be carefully deburred and cleaned. the cylinder bore must have a leading edge chamfer. profile K08-SE can be snapped into closed grooves.

**seal & housing recommendations**

*please note that we are able to produce those profiles to your specific need or any non standard housing. for detail measurements, please see seal-mart catalog...*

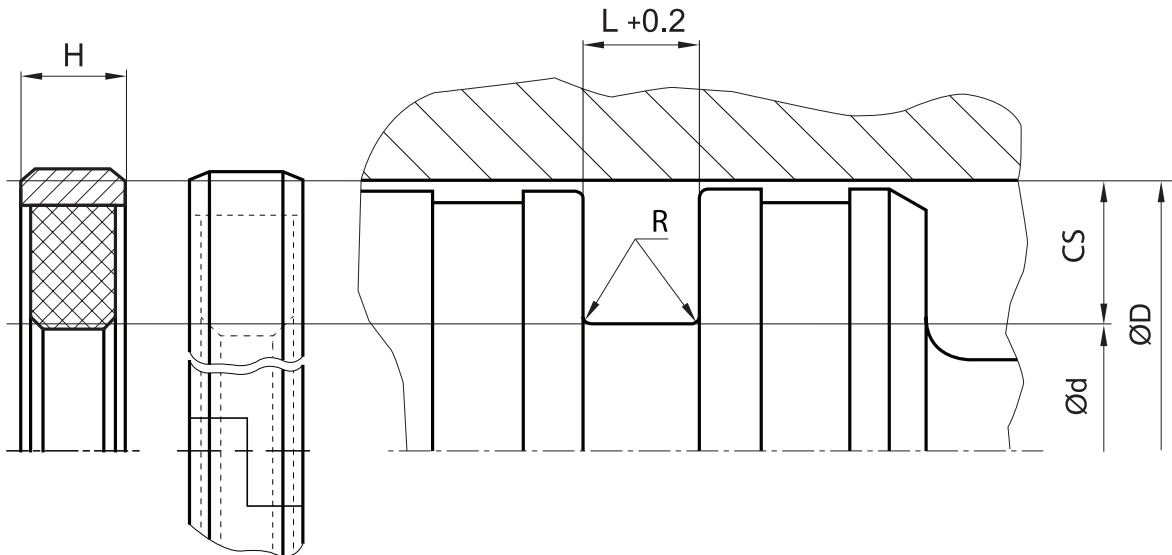

ØD	R
ØD < 63	0,5
ØD > 63	0,9

*don't hesitate to contact our technical department for further information or for special requirements (temperature, speed etc.), so that suitable materials and/or designs can be recommended.*